



## App Architecture

app-arch.com | 937.836.8898

**Architectural/Interior Design Innovators** - We consistently deliver creative design solutions which address complex issues and enhance peoples' quality of life.

**Trusted partners** - We maintain long standing partnerships with our clients by providing valued services.

**Strong collaborators** - We build trust with each client by listening, understanding needs and collaborating to address those needs through efficient and effective design solutions.

## Strong Core Values

**Integrity - Reliability - Collaboration - Responsiveness**

## Effective Methodologies

App Architecture staff brings a wide range of expertise to our work and combines proven experience with innovation. Each project is led by a principal of our firm who is on board for the duration of the project and is responsible for overall quality and responsiveness of the design and ensuring a smooth process.

**Listen and Learn:** Active Listening • Collaboration • Key stakeholders have a voice • Determine needs • Set clear objectives

**Explore Alternatives & Communicate Ideas:** Best practices • Design options • Prioritized budgets • Schedules • Clear written/graphic communications • Animations/Virtual Reality

**Implementation:** Clear and concise bid documents • Responsiveness

## Positive Results - Client Feedback

**Communication:** "We hired App Architecture based on the following qualities: listening skills, incorporating all agreed upon ideas and suggestions and effectively communicating with the customer."

**Responsiveness:** "We find every member of the App Architecture team to be responsive to our needs and committed to a successful outcome. Their attention to detail is very thorough which limits unplanned occurrences resulting in budget overruns."

**Meeting our clients' expectations, honoring our commitments and delivering projects on time are core principles of our firm and the foundation of a strong, collaborative partnership.**

## Key Team Members:

**Marianne Weber, AIA, NCARB**  
Managing Principal | Architect  
Years of Experience: 41 total/37 with App Architecture  
marianne.weber@app-arch.com

**Todd Gindelberger, AIA**  
Principal | Architect  
Years of Experience: 41 total/38 with App Architecture  
todd.gindelberger@app-arch.com

**Maria Schertler, AIA, NCARB**  
Principal | Architect  
Years of Experience: 32 total/4 with App Architecture  
maria.schertler@app-arch.com

**Charles Kent, Associate IIDA II**  
Interior Designer  
Years of Experience: 37 total/24 with App Architecture  
charlie.kent@app-arch.com

**Brenda Lynn**  
Mgr. of Construction Administration/Estimator  
Years of Experience: 32 total/8 with App Architecture  
brenda.lynn@app-arch.com

### Engineering Partners:

App Architecture utilizes trusted partners for various engineering services based on project requirements.

App Architecture has an ongoing, long term relationship with **Tri-Tech Engineering** (a SOEPC pre-qualified design professional) and welcomes the opportunity to partner with them on SOEPC Member projects. Together we provide full architectural, interior design, MEP and structural engineering services

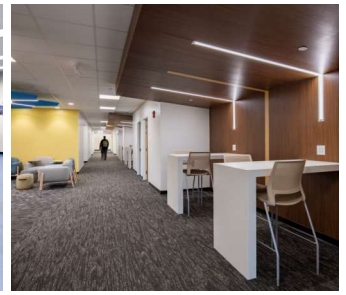

## Firm Approach

App Architecture is team-focused, engaging our clients in a collaborative process. This can range from design inspiration sessions, facilitating events to engage clients in creating artwork or spending time onsite to observe work environments and processes. We focus on relationship building. We help transform a vision to reality. We are passionate about our work.

## Representative Client Base (Ohio)

Northmont City Schools

Archbishop Carroll High School

Salem Christian Academy

Dayton Public Schools

Dayton Christian Schools

Miami Valley Career Technology Ctr.

Edison State Community College

Wright State University

Sinclair College

Miami University

Southern State Community College

Incarnation School

## Data

2026 marks our 44th year of business, in Englewood, Ohio. We currently have twenty-four dedicated staff including nine architects, two interior designers, two construction administrators, eight architectural design professionals and one Production/Revit Technician. All of our team members are familiar with State of Ohio bidding processes.

## Interior Design Services

We offer a full complement of services including budget development, furnishings, window-treatments, artwork and signage selection/specification. We can provide selection and specification for bidding or work with pre-approved vendors.

## Visualization Capabilities

Our staff provides virtual reality (VR) immersion, schematic concept images, photo realistic imagery, high resolution renderings and fly through video animations.

## Quality Control

We consistently produce clear/concise construction documents. Non-Owner requested Change Orders for our projects are consistently below 1% of construction cost, and well below the industry standard of 3-4%.

Regarding a \$19.2M new build project the Construction Manager made the following statement :

*"I wanted to send you a note thanking App Architecture for their care in preparing the construction documents. . . They were one of the most complete sets of drawings and specifications that I have used to build a project." - Matt Huelsman, Shook Construction*

## Budget & Schedule Management

Our team consistently performs on schedule and on budget by constantly monitoring the workload within our office and using specialized software tools. Meeting client's expectations, our commitments and project deadlines are of utmost importance to our firm and is the foundation of a team-oriented and collaborative working relationship.